

## Zubehör

Accessories  
Accessoires  
Accesorios  
Accessori  
accessoires  
tillbehör  
lisävaruste  
Accessórios  
akcesoria  
příslušenství

## Montageanleitung

Installation instructions  
Instructions de montage  
Instrucciones de montaje  
Istruzioni di montaggio  
Montagehandleiding  
Monteringsanvisning  
Asennusohje  
Instruções de montagem  
Instrukcja montażu  
Montážní návod

# Schubladen System

Drawer system

Système de tiroirs

Sistema de cajones

Sistema di cassetti

Ladesystem

Lådsystem

Laatikon järjestelmä

Sistema de gavetas

System szuflad

Zásuvkový systém

Teilenummer	2HJ-061-166
Part number	
Numéro de référence	
Número de pieza	
Codice articolo	
Onderdeelnummer	
Artikelnummer	
Osanumero	
Número de peça	
Numer części	
Číslo dílu	

**Amarok ⇨ 2023 -**

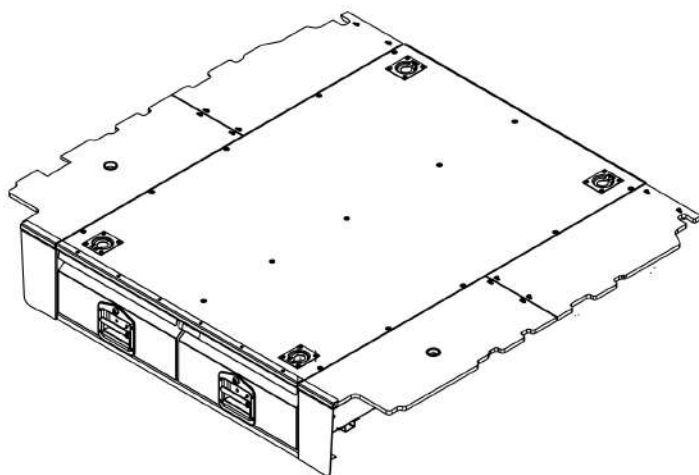

Änderungen des Lieferumfangs vorbehalten.

We reserve the right to make changes to the scope of delivery.

Sous réserve de modifications du contenu de la livraison.

Reservado el derecho a modificar el conjunto de suministro.

Soggetto a variazioni di fornitura.

Wijzigingen van de omvang van de levering voorbehouden.

Vi förbehåller oss rätten att ändra leveransomfånget.

Oikeus toimitussisällön muutoksiin pidätetään.

Reservado o direito a alterações do material fornecido.

Zastrzegamy zmiany zakresu dostawy.

Změny obsahu dodávky vyhrazeny.

Distributed by: Volkswagen Zubehör GmbH,  
An der Trift 67, 63303 Dreieich, Germany

UK: Distributed by Volkswagen Group United Kingdom Ltd.,  
Yeomans Drive, Blakelands, Milton Keynes, MK14 5AN,  
United Kingdom

notes

Dear customer,

Congratulations on choosing this VW accessory.

This manual contains important information, advices, introductions and warnings on fitting and using this component in your vehicle which must be strictly adhered to. Please also read and observe the information's and warnings kept in the vehicle manual.

Volkswagen Zubehör work continuously to develop and further improve all products. This is why it is possible to alter any part of the scope of delivery equipment and technology at any time. The data provided concerning scope of delivery appearance and functions of the product correspond to the information available at the time of its going to print

Tools to be used

- 1. Hand Drill
  - Drill bit
    - Ø 6.5 mm.
    - Ø 7.5 mm.
    - Ø 12 mm.
- 2. Rivet gun
- 3. Wrench No. 17, No.10
- 4. Hex wrench No.4
- 5. Phillips screw driver
- 6. Tape measure
- 7. Marking pen

List of content

issue	page
warnings	En - 1
advices	En - 1
scope of delivery	En - 2
Tools to be used	En - 1
mount of scope of delivery	En - 3

 warnings

- 1. The assembly of this scope of delivery must be performed at a specialist workshop!
- 2. Only use undamaged tools to implement of all the work steps.
- 3. The occupational health and safety must be adhered to during the work!

 advices

- 1. All Drilling into the tub floor must have the drill depth restricted to 10 mm damage to critical hardware under tub floor may occur if this is not followed
- 2. This product can not fitted with Roller Shutter, Divider, Utility Box or Spray on Bed liner

- Read instructions completely & carefully before commencing fitment.
- Estimated Fitting Time: 2 Hrs
- Left and right hand components are determined as seated in the vehicle.
- Check for (and remove) any protective coating build up in all captive nuts.

Bolt tensions	Dia. (mm)	Nm	ft.lbs	Dia. (inch)	Nm	ft.lbs
All bolt tensions are as follows unless otherwise specified.	5	5	4	1/4"	8	6
	6	8	6	5/16"	18	13
	8	18	13	3/8"	33	27
	10	44	32	7/16"	55	43
	12	77	57	1/2"	86	66

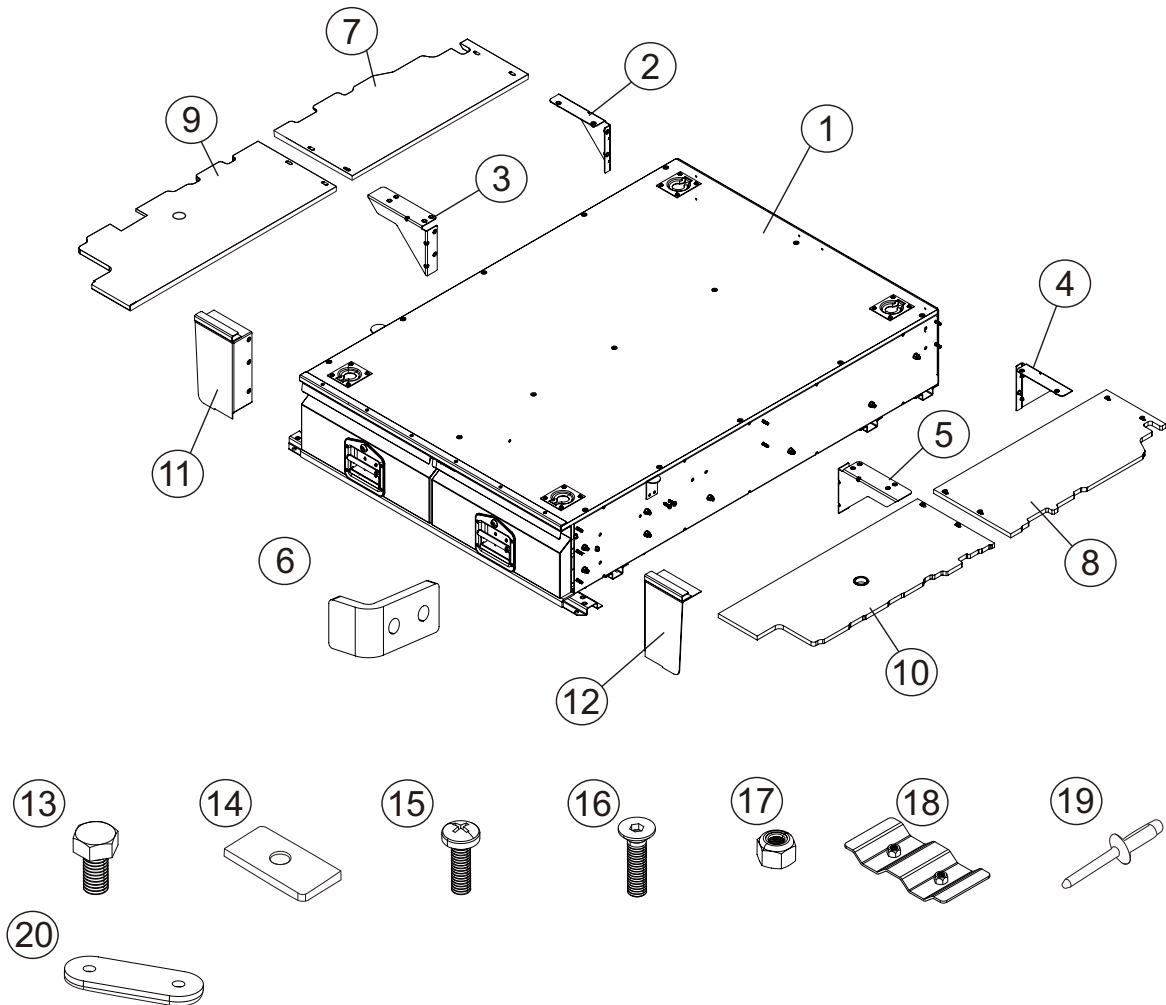

**2HJ-061-166**

**PARTS LIST**

ITEM NO.	Description	Qt	Part Number
1	Twin Draw System Unit	1	-
2	190mm LH WING BRKT	1	-
3	220mm RH WING BRKT (Modify)	1	-
4	190mm RH WING BRKT	1	-
5	220mm LH WING BRKT (Modify)	1	-
6	Draw Side Stop brackets	4	-
7	Amarok 2022 DBL Rear P-Side Fixed Panel (with liner)	1	-
8	Amarok 2022 DBL Rear D-Side Fixed Panel (with liner)	1	-
9	Amarok 2022 DBL Front P-Side Lift Out Panel (with liner)	1	-
10	Amarok 2022 DBL Front D-Side Lift Out Panel (with liner)	1	-
11	Amarok 2022 DBL Front P-Side Fascia Panel (with liner)	1	-
12	Amarok 2022 DBL Front D-Side Fascia Panel (with liner)	1	-

**BOLT KIT**

13	M10 x 1.5 x 40mm Hex Head Screw	8	-
14	M10 x 50mm x 25mm Rectangular Washer	8	02-W50253-01
15	M6 x 20 Pan Head Screw	26	-
16	M6 x 30 CSK Head Stainless Screw	12	-
17	M6 Nylon nuts	8	-
18	Floor mounting reinforcement plates	4	-
19	1/4" steel structural rivets - Hemlok	24	2221-00813
20	Shim plate thk 18 mm	4	-

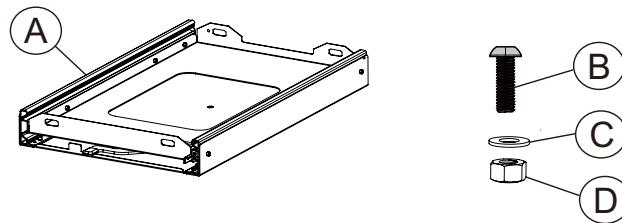

**FRIDGE SLIDE +COMPONENT**

**2HJ-061-166-B**

**PARTS LIST**

ITEM NO.	Description	Qty	Part Number
A	Fridge Slide Assembly	1	420244000001

**BOLT KIT**

B	M6x1.0x25 mm Dome Head Screw	6	-
C	M6 Washer	6	-
D	M6x1.0 Nylon lock Nut	6	-

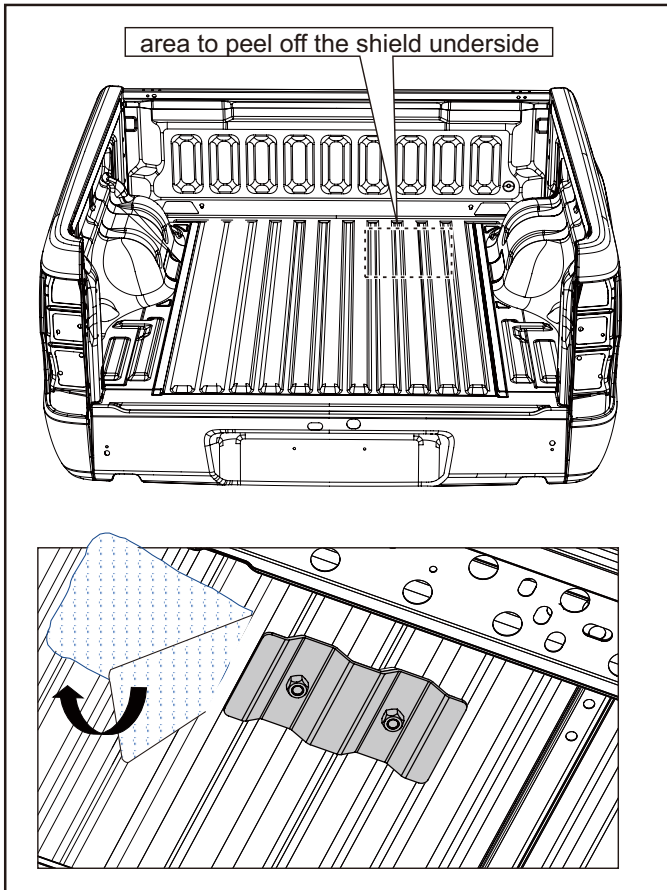

1. Prepare the vehicle for installation:  
- Remove Bed liner

*Note: If the vehicle does not have a bedliner, refer to fitting instructions for without bedliner*

The spare wheel must be removed.

It is required to peel back 1/3 of the heat shield on the underside of the tub floor prior to drilling the floor for mounting plates at show location.

*Note: After securing underside mounting plates reattached the heat shield by pressing firmly back onto the body.*

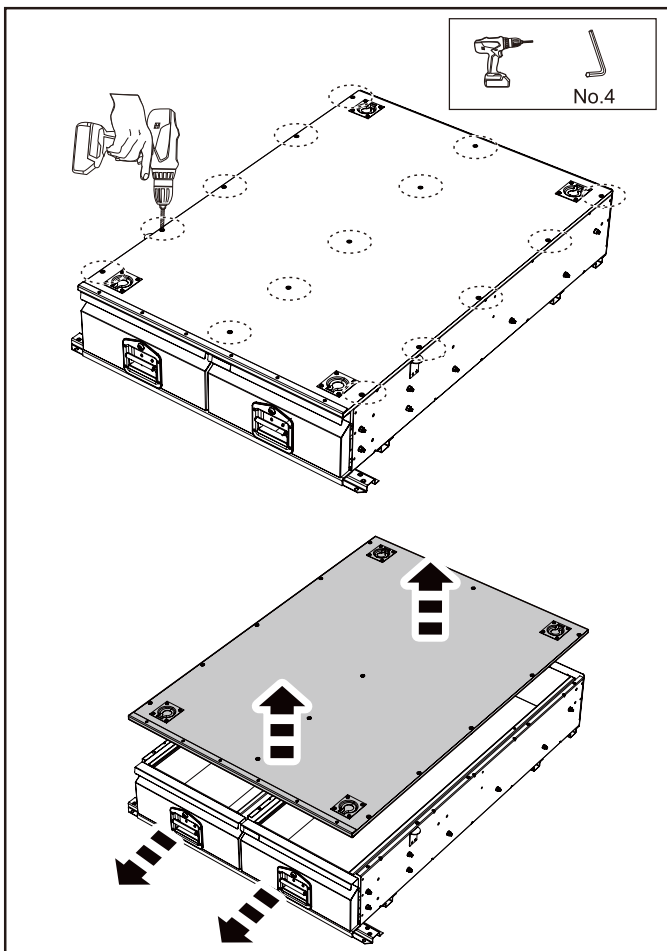

2. Prepare the drawer system for installation.  
Remove the top panel assembly.

DO NOT remove the front alloy trim edge and 4 x tie downs from the top panel assembly.

3. Carefully remove the draws fully from the frame and set aside.

Note: TAKE CARE the draw opening stopper brackets that prevent the draws from coming completely out IS NOT INSTALLED as delivered.

Also note which drawer came from which side (left and right)

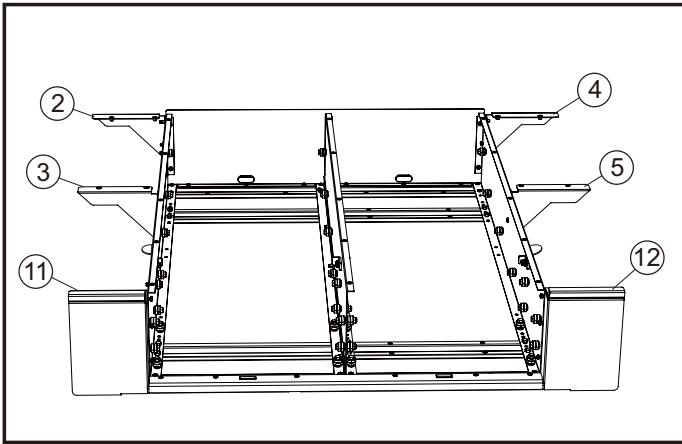

4. Place the chassis assembly in the vehicle and attach the front fascia panel brackets; items 11 & 12 using the M6 x 20 pan head screw item; 15. fit the draw Wing these can be tightened fully Brackets items; 2, 3, 4, & 5 using the M6x20 pan head screws item; 15. Fit the contour panels items; 7, 8, 9, & 10 using the M6 x 30 CSK stainless screws item; 16 to confirm alignment to tub.

Do not fully tighten any of these top panel & contour panel screws.

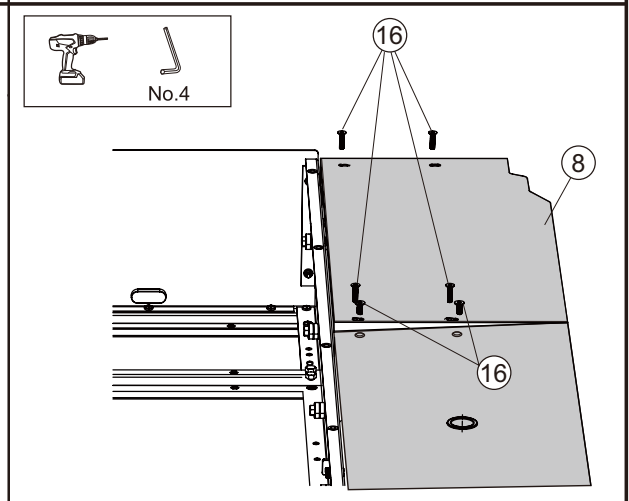
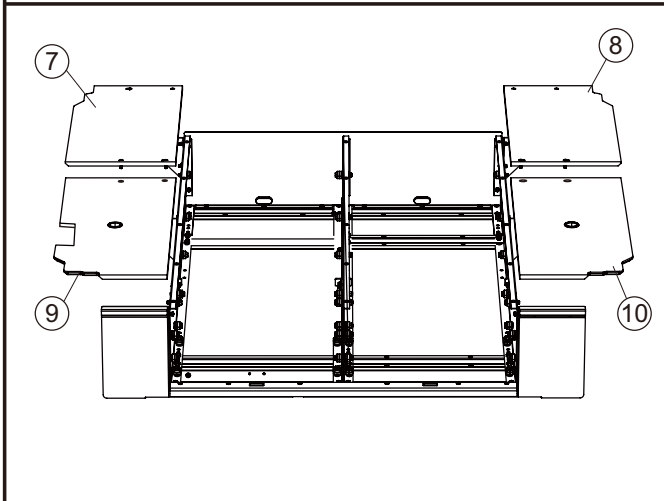
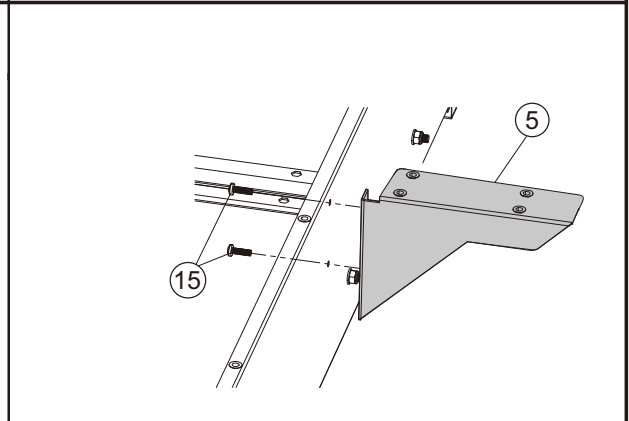
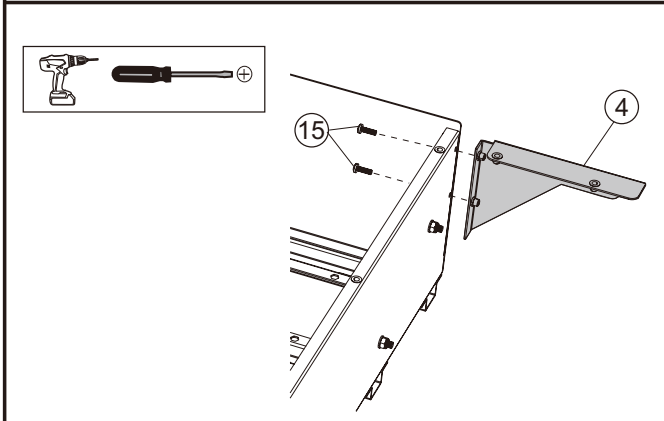
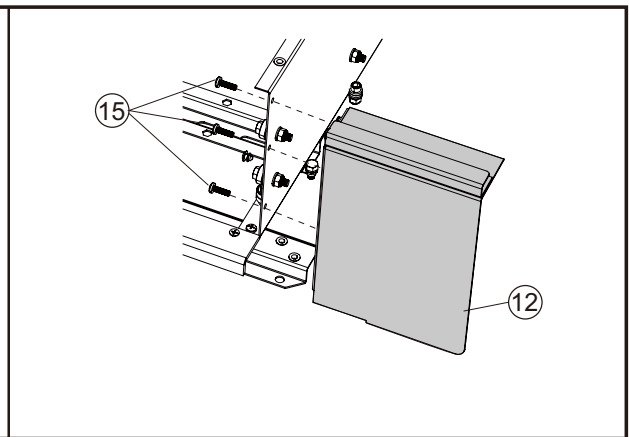
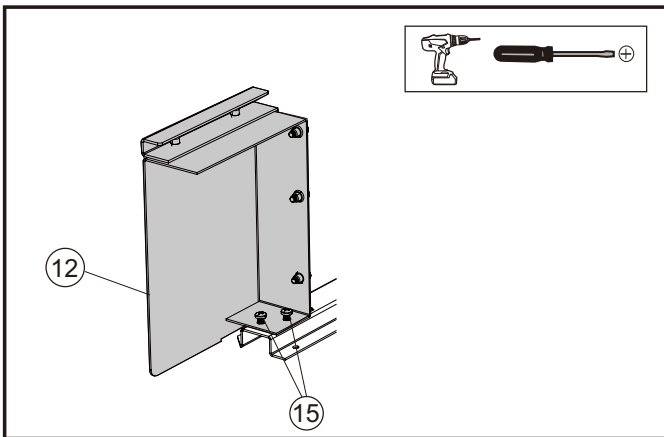

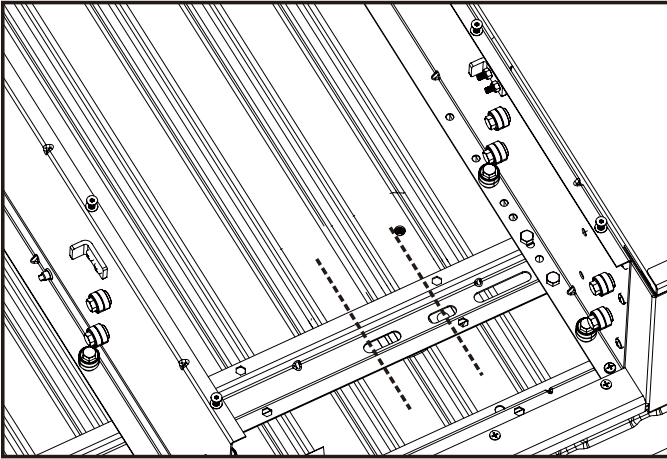

6. Mark drilling positions through the cross-member frame holes/slots  
The drilling positions on the left and right sides should fall on the center of the tub peak ridges in the floor.

If this is not the case, ensure the unit is central and the contour panels are aligned correctly BEFORE PROCEEDING.

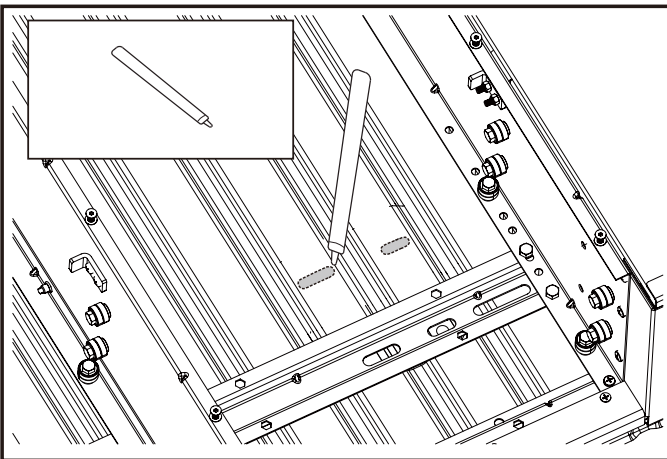

7. Once the unit is correctly positioned as shown, using a pen/Texta trace the outline of the slot in the ribs.  
Repeat this step for all mounting positions.

8. Remove side contour panels, then lift drawer chassis assembly from the tub and set aside

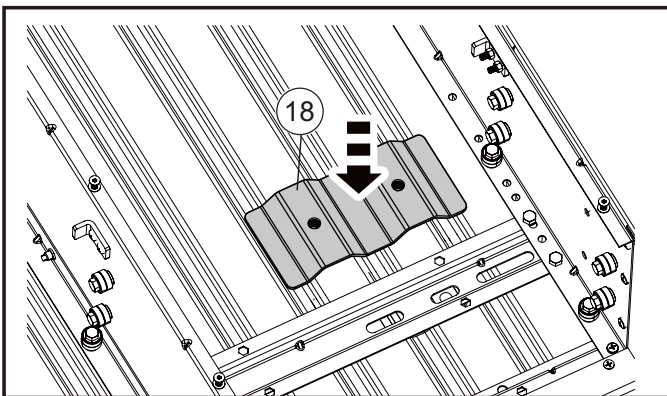

9. Position the under floor mounting bracket item ; 18 over the previously marked slots  
Ensure the bracket is placed centrally to the peak in the floor rib as pictured.  
Mark the floor where where it's intended to be drilled.

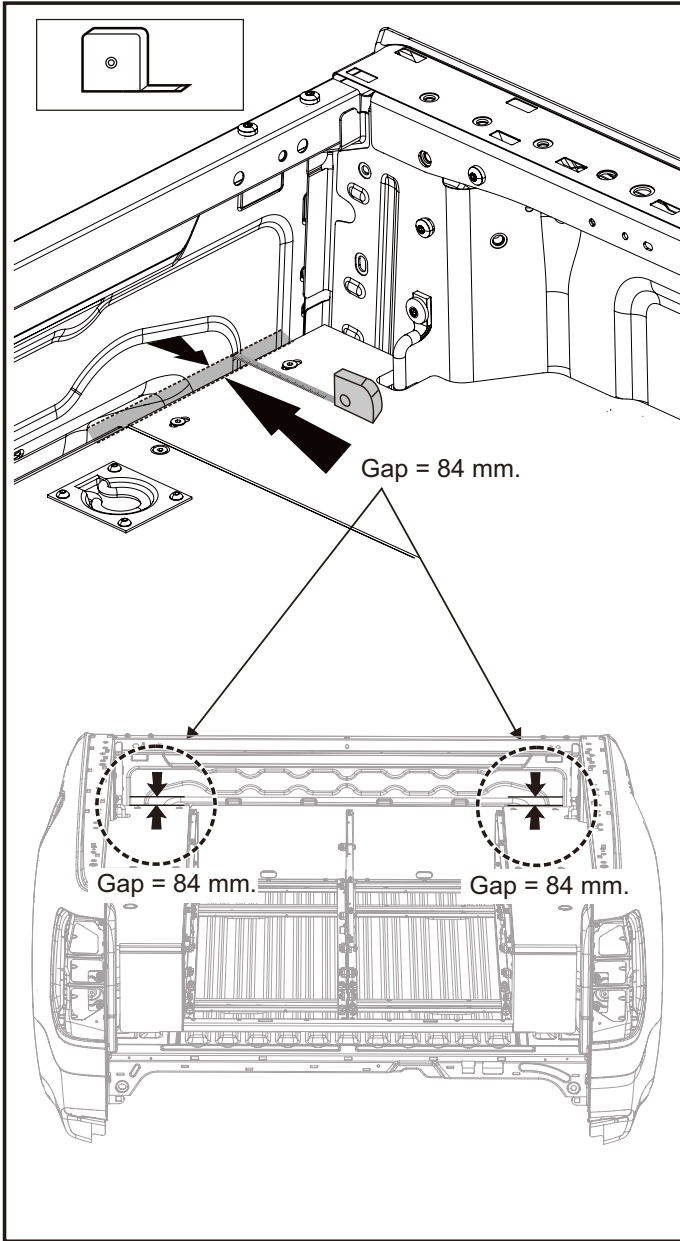

5. Place the drawer chassis assembly in the vehicle. This step is critical to ensure that the unit is aligned & centralized in the tub against the contour panels. Position the unit to allow drilling points to be marked. It is critical that the unit is:

- Central in the tub with equal gap on both sides
- Square/parallel to the tub headboard with 84 mm. gap front the front top profile (refer image below)



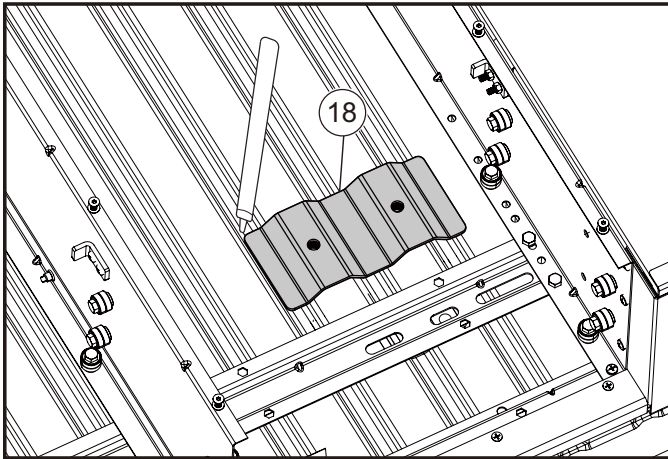

10. Trace around the under floor mounting bracket item;18 leaving an outline for reference.

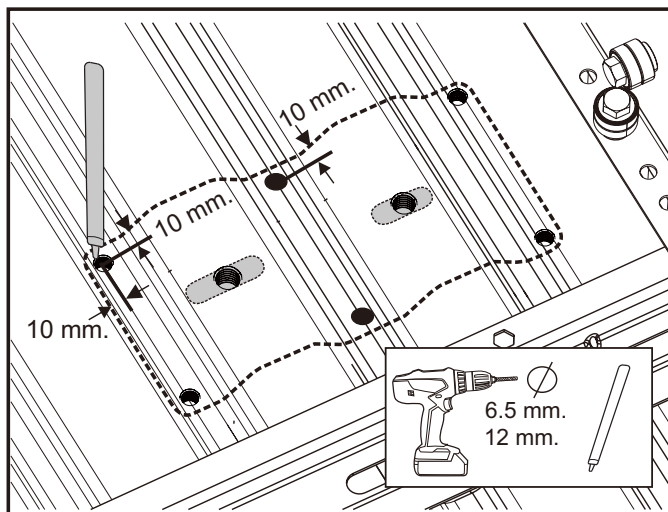

11. Mark rivet hole locations 10 mm inboard from each corner edge and centre (6 positions per bracket) as shown for drilling & installation of rivets. Repeat Steps 8 to 11 for all 4 Brackets.

12. Drill the 2 x centre bolt holes in the top of the ridge to 12mm diameter using a step drill bit.

13. Vacuum any swarf left in the vehicle tub after drilling.with stop set to 10 mm

Treat exposed surfaces of holes using brush on or spray on Cold Galvanizing Compound or rust preventative sealing paint.

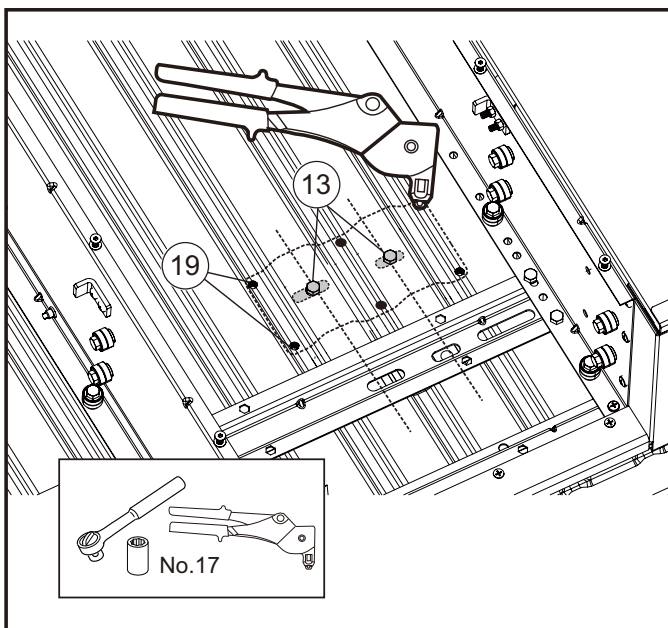

14. Install the under floor mounting bracket item;18 from underneath the vehicle and fasten using M10X40 Hex Head Screw item;13 ensuring the mounting bracket is pulled up tight to vehicle body.

15. Drill the 6 rivet holes through the floor & under floor bracket as previously marked in Step 11 using; Dia 6.75mm drill bit with stop set to 10mm.

16. Vacuum any swarf left in the vehicle tub after drilling.

Treat exposed surfaces of holes using brush on or spray on Cold Galvanizing Compound or rust preventative sealing paint.

17. Install 1/4" steel rivets item;19 into each bracket (6 positions per bracket). Repeat Steps 14 to 16 for all 4 brackets.

18. Remove the M10 x 40 Hex Head Screw.item;13

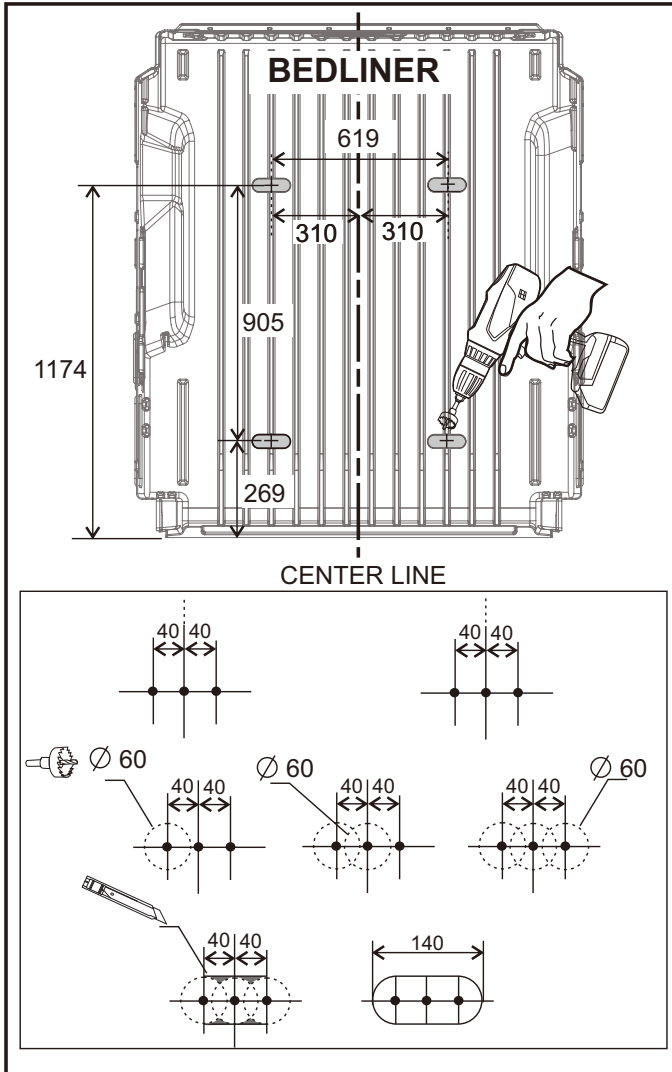

19. Make 4 slots (by holesaw diameter 60 mm. and cutter) on the Bed liner as shown on the left picture.

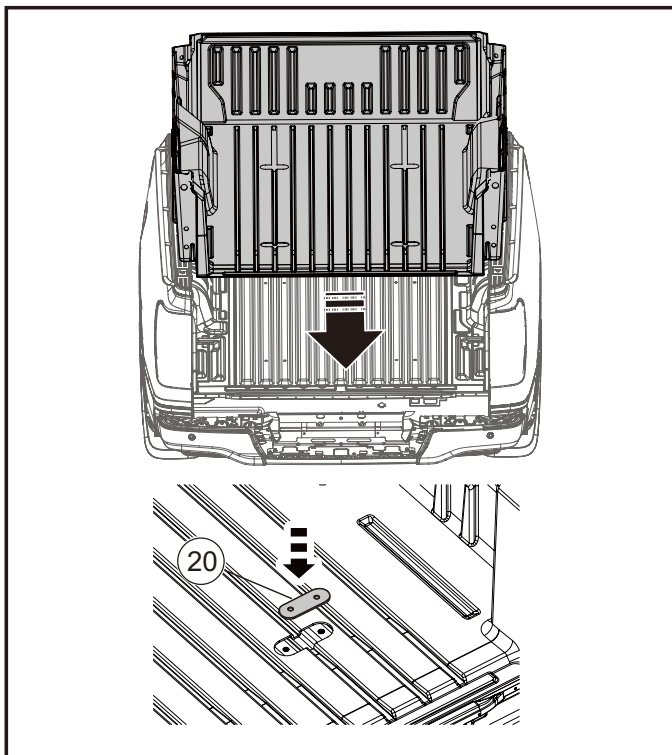

20. Reinstall the bedliner to the vehicle tub and place the shim plate (18mm thick – 4 pcs) in the slots item ; 20.

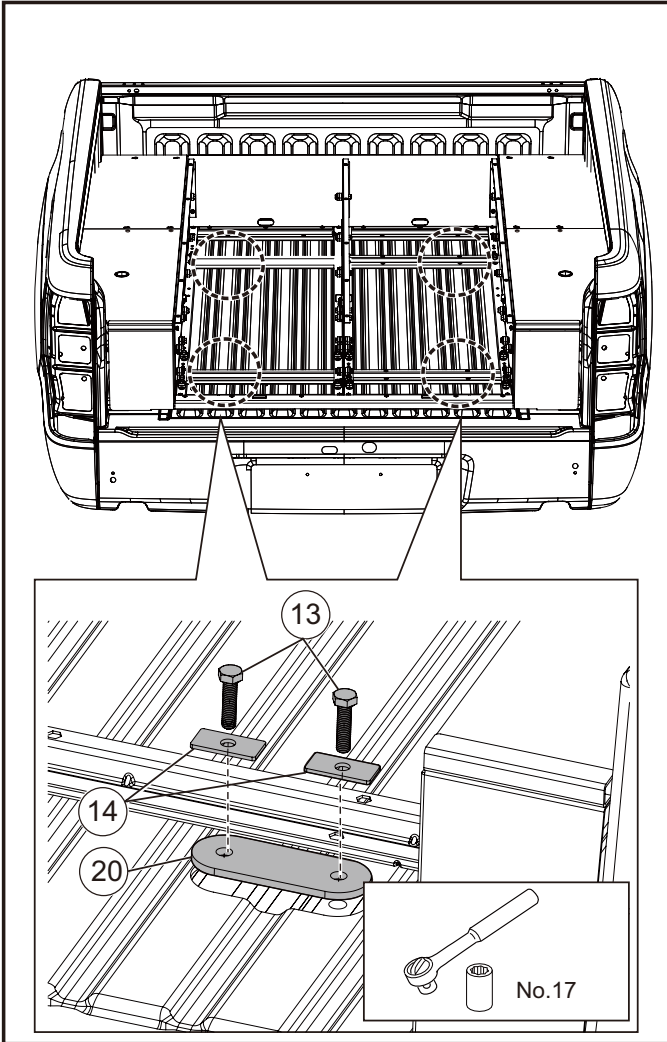

21. Lift drawer chassis assembly back into the vehicle tub and reinstall side contour panels. Align the frame back to the centre of the tub as per Step 5.

Fasten the unit to the vehicle using M10x40 Hex Head Screw item:13 with 25x50 mm. rectangular washers item:14 and shim plate thk 18mm. item:20 under the has show

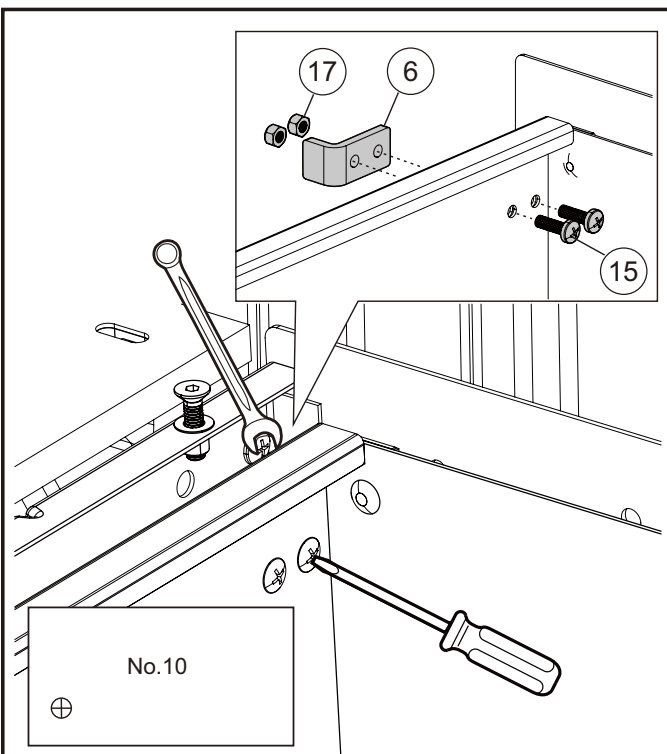

22. Reinstall the draws back into the chassis frame assembly as they were removed in Step 6 (left and right).

23. Install the draw side stop brackets item; 6 2 pcs per draw positioned in the back left and right top corners that prevent the draws from falling out under normal use.

Fasten the stop brackets using M6 x 20 pan head screws item; 15 to the inside of the drawer and M6 Nyloc nut item; 17 to the outside.

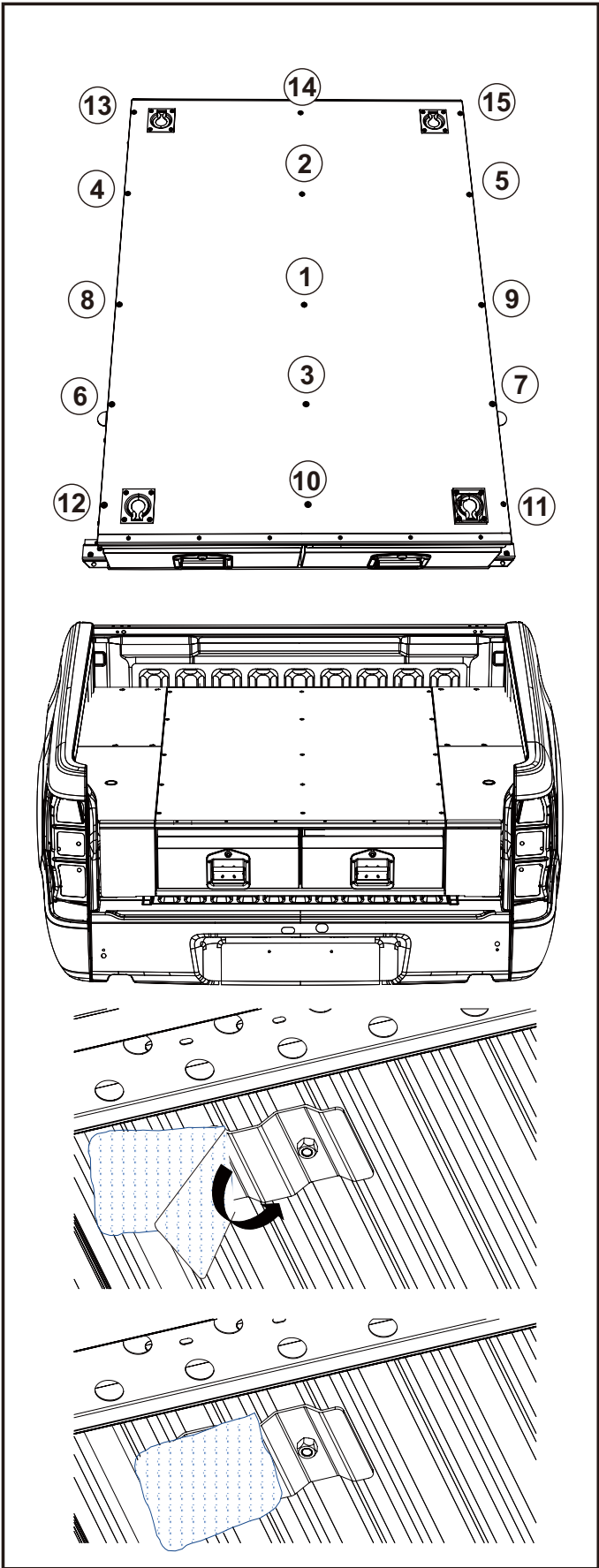

24. Re-attach the top panel assembly using the following tightening sequence shown. And fridges slide (if applicable).

25. Check the draw system overall for smooth rolling of drawers, even gaps and any movement of drawers and slide functionality.

26. Adjust as required and wipe/vacuum unit down for presentation to customer.

27. Refit spare wheel. Firmly press to on refit the heatshield to the underside of the tub floor over the top of the draw system mounting bracket.

## Fridge Slide - Drawer System Accessory

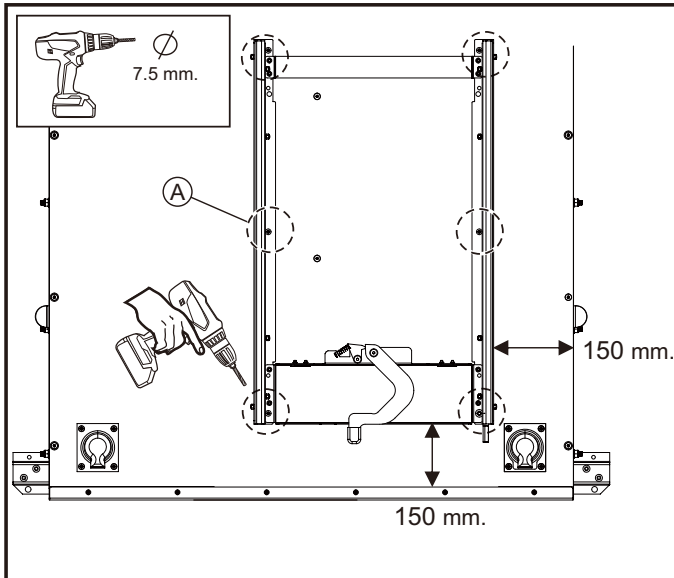

1. Prepare the Draw system for installation :

- The position of Fridge slide : 150 mm from Front and 150 mm. from side Draw system.

- Check the desired location allows the tailgate & Canopy rear door to properly close before proceeding .

- Ensure Slide Unit is only mounted to the central draw top and not the removable side wings.

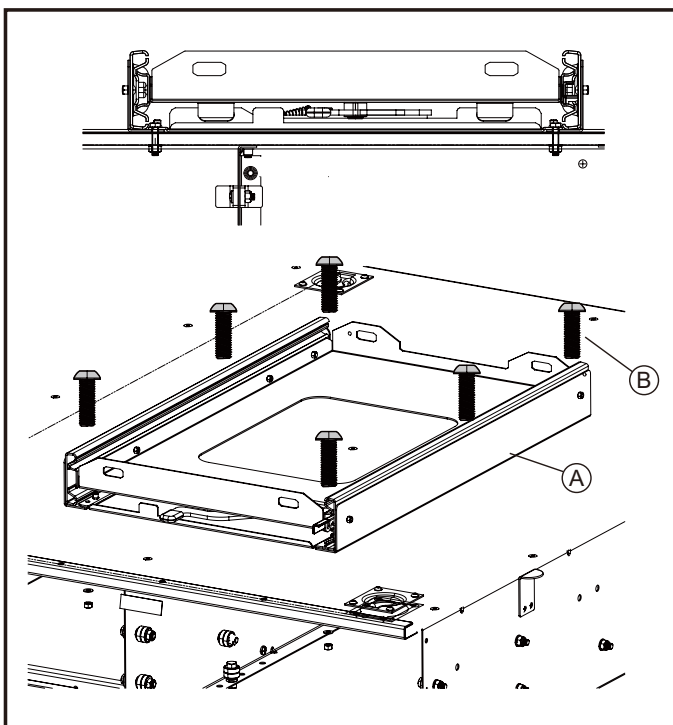

2. Using the Slide lower base as the hole template mark 6 positions from the 8 available base plate holes

3. Drill 6 holes **7.5mm Dia** Completely through from the top down (Carpet side) as marked in **STEP 2** above..

Take care to ensure the carpet is clamped down to avoid tearing .

4. Place fridge slide frame back on top of the drawer system and feed the bolts (x6) through the drilled holes.

Ensure carpet and draw top are free of swarf before returning the vehicle to the customer.

5. Install the nut D (x6) and washer C (x6) onto the bolts and torque to 8 N.m

