

INSTALLATION MANUAL

PRODUCT: TRANSFER CASE SKID PLATE

APPLICATION: FORD RANGER WILDTRAK (2022-)
FORD RANGER RAPTOR (2022-)
FORD EVEREST (2022-)

PART NO: 2111.1887.1.3
2333.1887.1
2333.1887.1.6



CAUTION!

To reduce the risk of serious injury or damage to property: Before you start installing and using this product, read the full instructions, pay special attention to the conditions of safe use and recommendations for installation! When installing or maintaining this product, it is necessary to use protective goggles. Check the integrity of the structure and the moment the fastening is tightened every 250 miles (400 kms) of mileage. Do not use this product if there is damage to the structure or fasteners!

NOTICE

Skid plate is an additional protection, but it can not guarantee to protect against all possible damage in collisions. When driving, be careful of objects and terrain that may damage sensitive parts of the vehicle.

TRANSFER CASE SKID PLATE

Part number 2111.1887.1.3
2333.1887.1
2333.1887.1.6

Suited to vehicle: FORD RANGER WILDTRAK 2.0L AT 4WD (2022-)
FORD RANGER RAPTOR 3.0L Biturbo V6 AT 4WD (2022-)
FORD EVEREST 2.0L AT 4WD (2022-)

Material: Steel / Aluminum

Compatibility: Rival 1886.1 Gearbox skid plate



SAFETY NOTICE

- * The RIVAL transfer case skid plate is designed to complement the use and design of the specified vehicle under conditions specified by the vehicle manufacturer.
- * While driving the vehicle at any speed, collision with any other vehicle, animal or object must always be avoided.
- * Following any collision with any other vehicle, animal or object, the RIVAL transfer case skid plate and the vehicle must be inspected by a specialized or suitably qualified vehicle repairer for possible damage to the components and assemblies in order to confirm suitability for further use of the vehicle.
- * It is strongly recommended that you do not operate a vehicle with a damaged transfer case skid plate or its components. In the case of damage, please contact the nearest RIVAL dealer. Vehicle, or where the skid plate has been damaged, is extremely dangerous and must be avoided at all cost.

INSTALLATION NOTICE

- * The RIVAL transfer case skid plate must be mounted and affixed to the vehicle according to this installation manual.
- * Personal safety during the installation process must be adhered to at all times.
- * Do not install this skid plate on vehicle models other than those allowed in this manual.
- * Estimated time for installation: 1 hour.

REQUIRED TOOLS

- * Basic tool kit
- * Torque wrench

TORQUE SETTING

- * M10 - 47 H·m (34.7 lb/ft)

PARTS LISTING

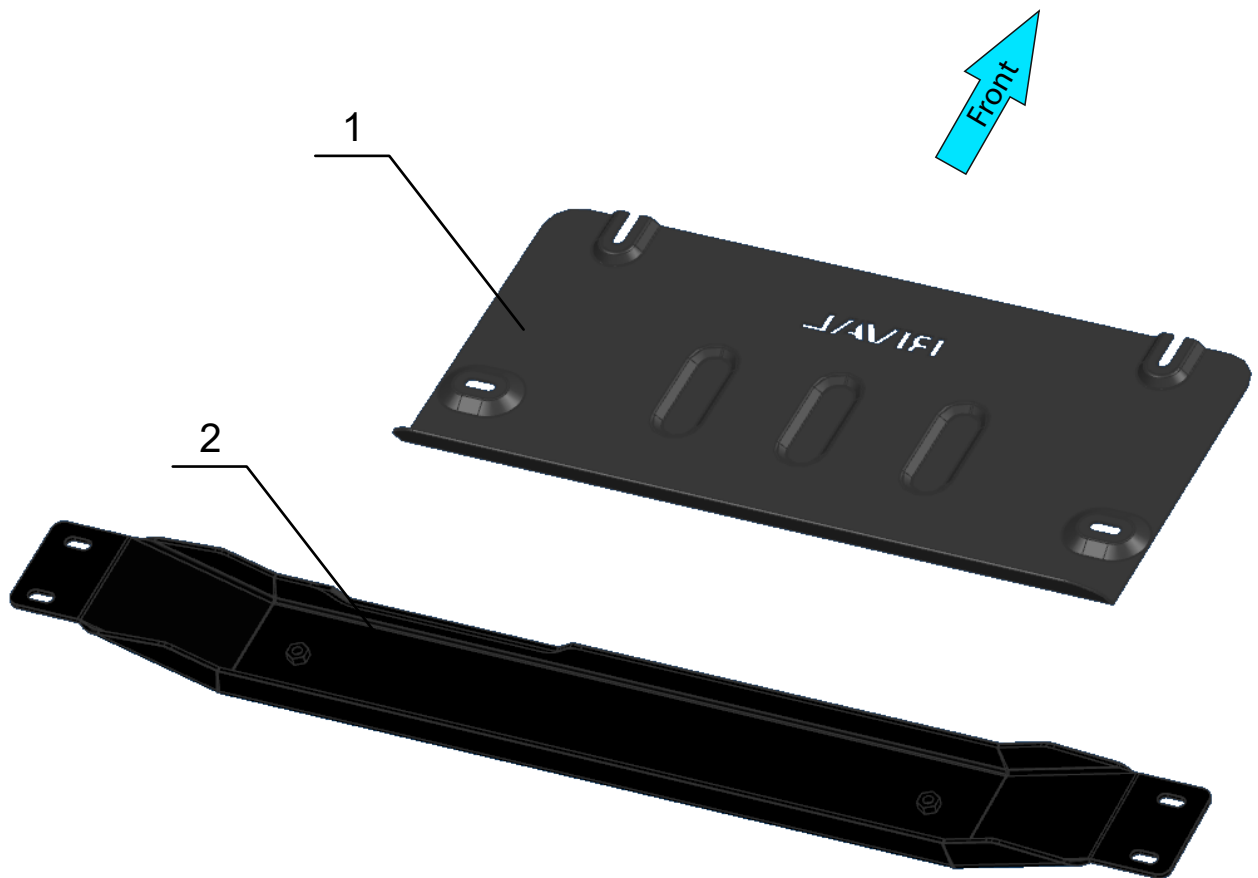

- 1. Transfer case skid plate.....Qty 1
- 2. Mount bracket.....Qty 1

PARTS LISTING

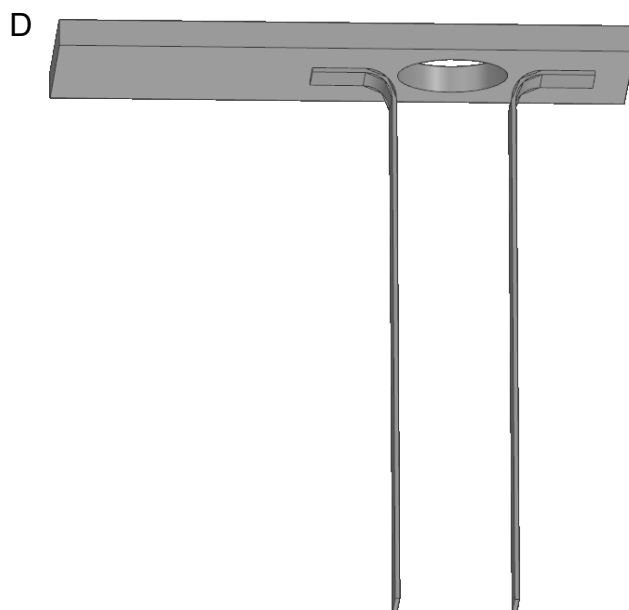
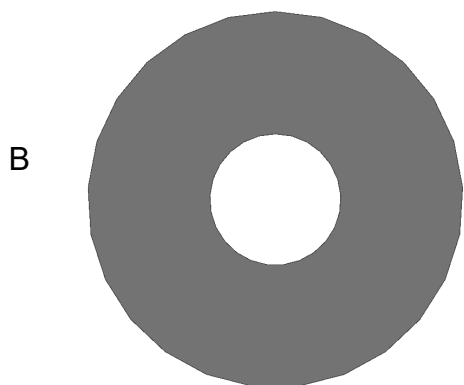
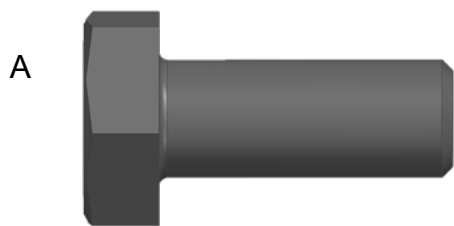

A. Bolt M10x25.....	Qty 10
B. Washer 10.....	Qty 10
C. Bracket.....	Qty 2
D. Insert nut M10.....	Qty 6

INSTALLATION PROCEDURE

***If equipped, remove the factory skid plate or any other aftermarket skid plate.**

*** Before installation: Unscrew bolts M10x25 (item A) and washers 10 (item B), preinstalled as travel hardware, in mount bracket (item 2) and transfer case skid plate (item 1). Set aside to reuse later on.**



Fig. 1



Fig. 2

1. Install the insert nut M10 (item D), as shown in fig.1 and fig.2.



Fig. 3

2. Fix the mount bracket (item 2) to insert nut M10 (item D), using bolts M10x25 (item A) and washers 10 (item B), as shown in fig.3.

***Tighten hardware after that.**



Fig. 4

3. Install the insert nut M10 (item D) or loosen rear bolts of RIVAL gearbox skid plate 1886.1, as shown in fig.4.

INSTALLATION PROCEDURE

For FORD RANGER WILDTRAK (2022-) and FORD EVEREST (2022-)

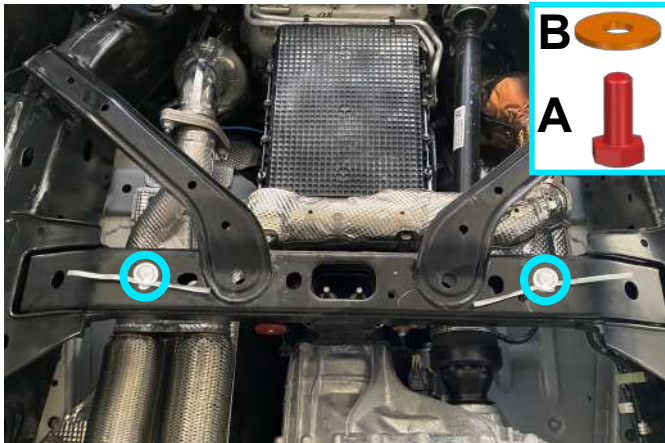

Fig. 5

4. Loosen bolts M10x25 (item A) and washers 10 (item B) in front mounting points (Fig.5).

***Do not tighten yet.**

****If you have RIVAL gearbox skid plate 1886.1 installed, skip this step.**

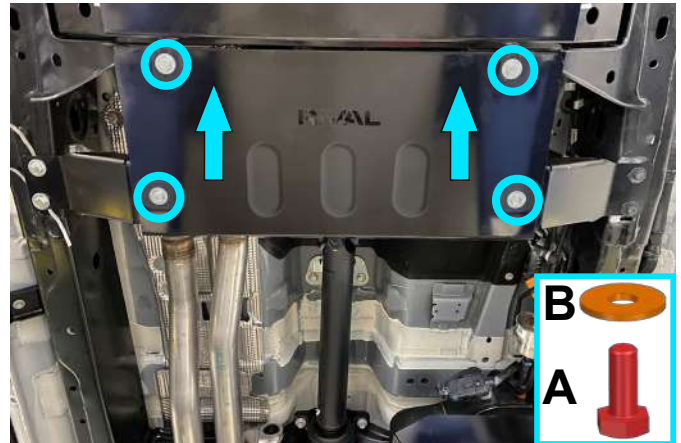

Fig. 6

5. Put transfer case skid plate (item 1) on installed bolts M10x25 and washers 10 from step 4. Fix the rear part of skid plate to mount bracket, using bolts M10x25 (item A) and washers 10 (item B), as shown in fig.6.

***Tighten hardware after that.**

For FORD RANGER RAPTOR (2022-)

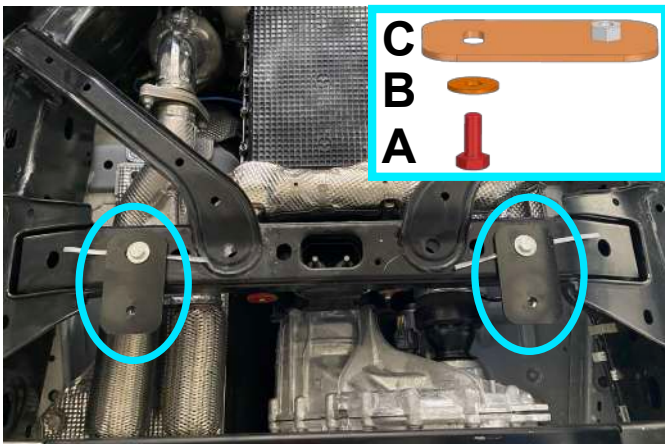

Fig. 7

6. Fix brackets (item C) to installed insert nut M10 (item D) from step 3, using bolts M10x25 (item A) and washers 10 (item B), as shown in fig.7.

***Tighten hardware after that.**

****If you have RIVAL gearbox skid plate 1886.1 installed, skip this step.**

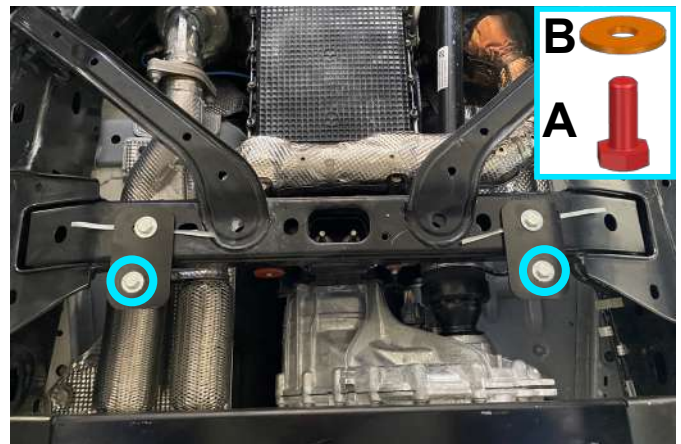

Fig. 8

7. Place bolts M10x25 (item A) and washers 10 (item B) to brackets (item C), as shown in fig.8.

***Do not tighten yet.**

****If you have RIVAL gearbox skid plate 1886.1 installed, skip this step.**

INSTALLATION PROCEDURE

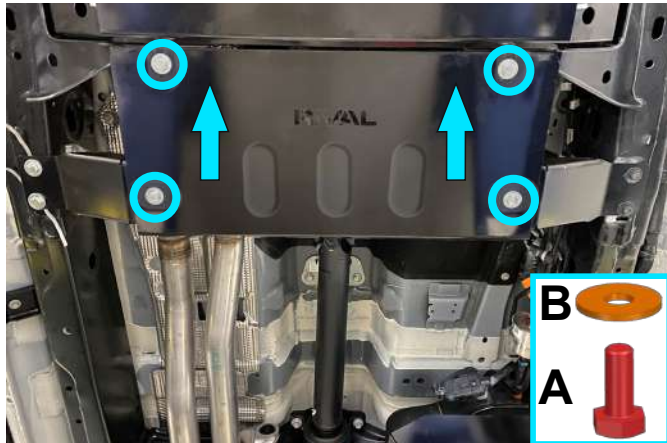

Fig. 9

8. Put transfer case skid plate (item 1) on installed bolts M10x25 and washers 10 from step 7. Fix the rear part of skid plate to mount bracket, using bolts M10x25 (item A) and washers 10 (item B), as shown in fig.9.

***Tighten hardware after that.**

INSTALLATION PROCEDURE

Before operating a vehicle fitted with RIVAL Skid Plate:

- make sure all fittings are tightened;
- ensure the integrity of the structure and its components.

